

Dimensional Data (inches and [mm]) are Subject to Manufacturing Tolerances and Change Without Notice

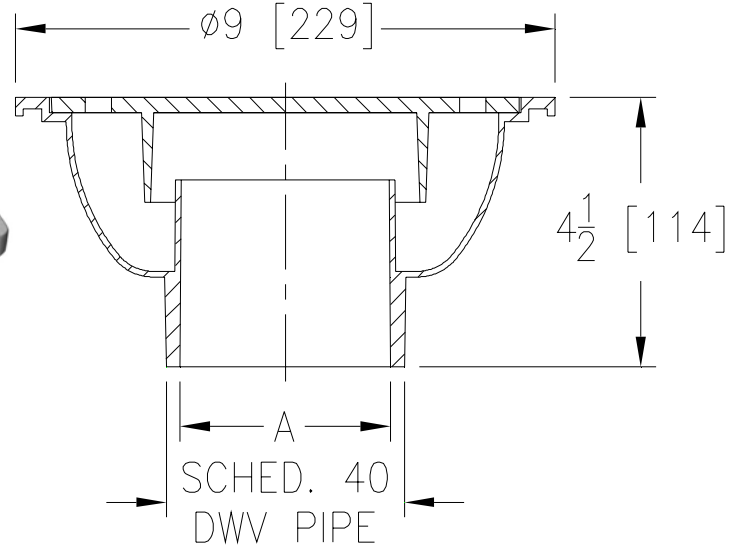

Product	'A' Outlet Connection	Grate Open Area Sq. In [cm ²]
___ FD2381-PVC	3 [76] x 4 [102] PVC Solvent Weld	43 [277]
___ FD2381-ABS	3 [76] x 4 [102] PVC Solvent Weld	43 [277]

FD-2381 9 x 9 [229 x 229] Bell Trap Drain

Recommended for unfinished areas, ideal for the garage and basement. The PVC or ABS drain body is designed to fit over 3 [76] or inside 4 [102] sched. 40 DWV pipe.

Typical Installation

